

1a

2a

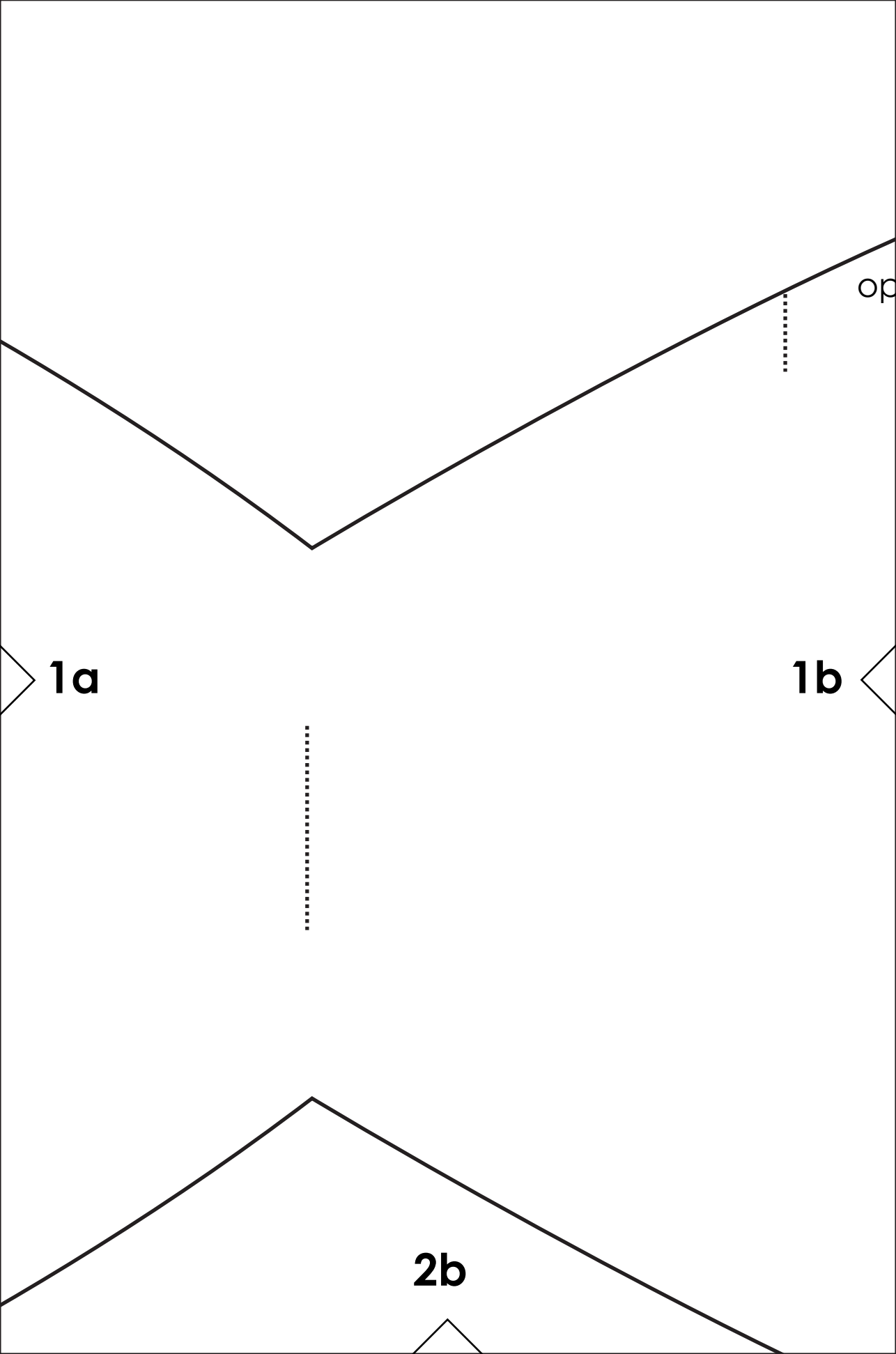

opening

1b

1c

Hook & Loop tape

4.

Prawn

Cut 2 (facing)

2c

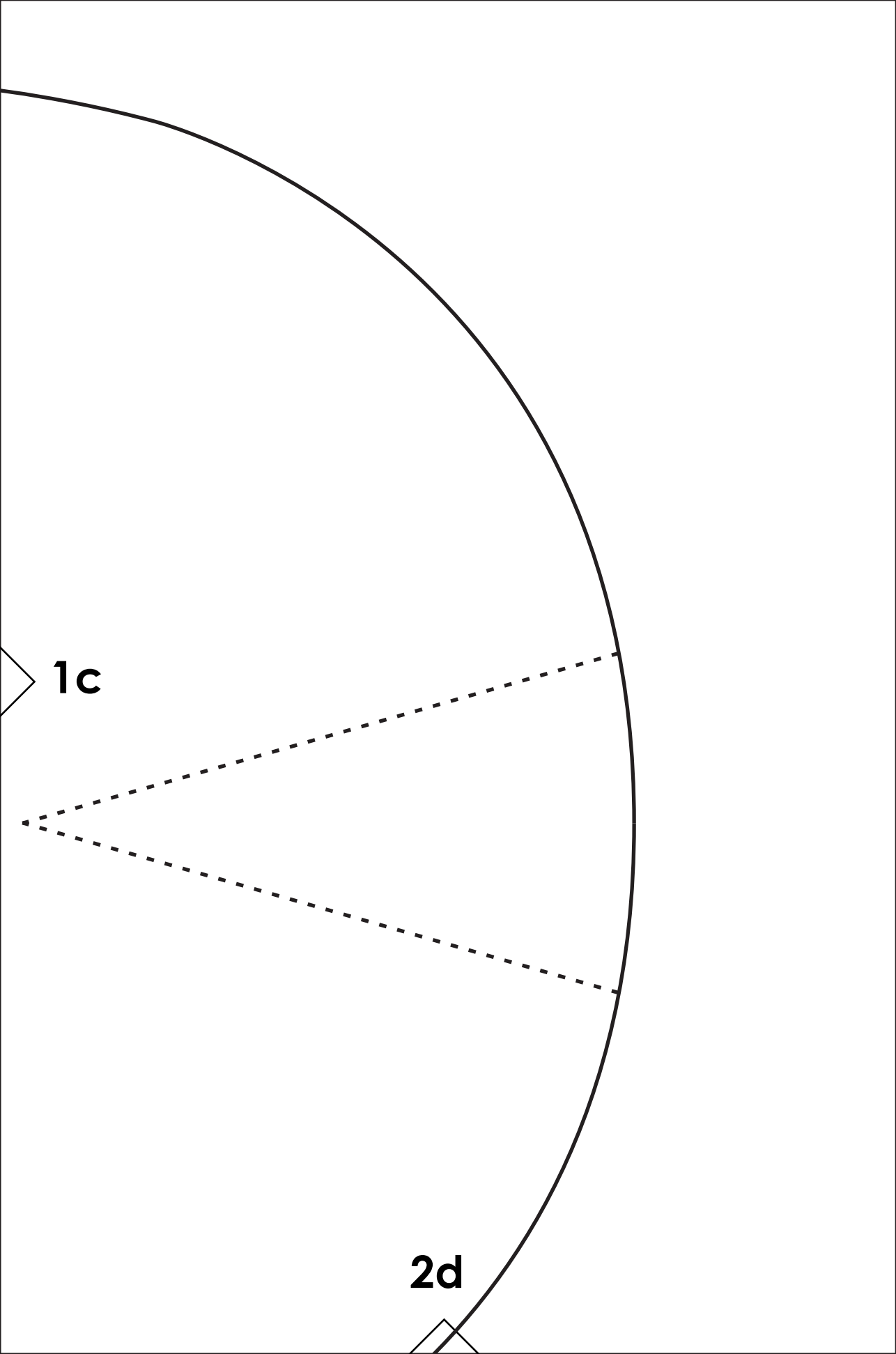

2a

3a

2. Sushi Rice

Cut 1 on fold

up tape

4a

2b

opening

3a

3b

4b

tape

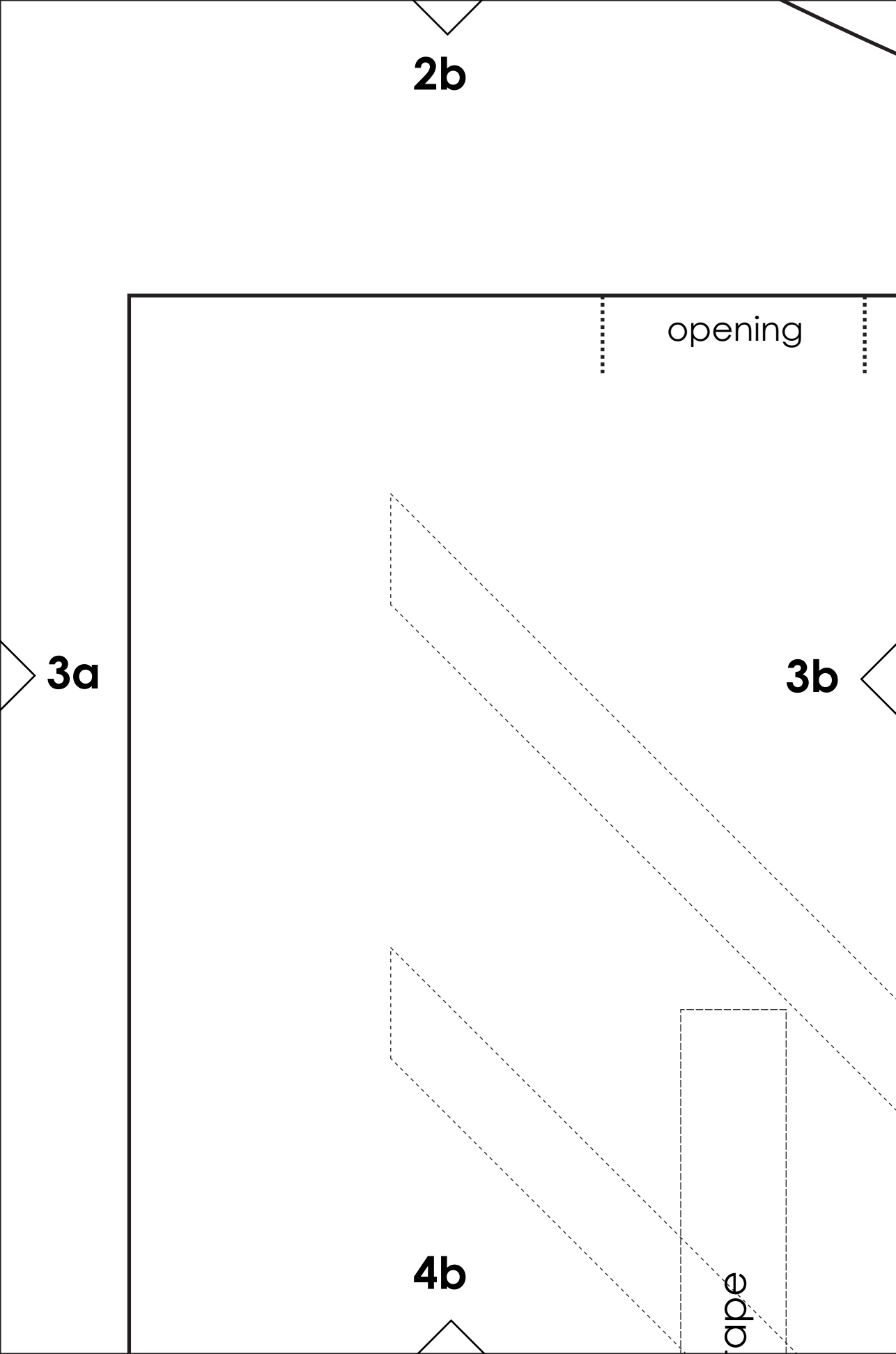

2c

3b

3c

4c

A diagram consisting of a large rectangle with a curved line at the top. The top boundary is a downward-curving arc. The left boundary is a vertical line. The right boundary is a vertical line. The bottom boundary is a horizontal line. A dashed parallelogram is located in the bottom-left corner of the rectangle. Four labels are present: '2c' at the top center, '3b' on the left side, '3c' on the right side, and '4c' at the bottom center. Each label is accompanied by a small triangle pointing towards the boundary it labels.

2d

FOLD

5. *Nori* Seaweed

Cut 2 on fold

4d

3c

4a

Hook & Loop

5a

Hook & Loop
tape

6a

FOLD

4b

Hook & Loop fastener

5a

5b

3. Tuna & Egg

Cut 2 (facing)

6b

A diagram showing a large rectangle with a smaller rectangle inside it. The top and bottom edges of the large rectangle are marked with triangles pointing inward, labeled '4c' and '6c' respectively. The left edge of the large rectangle is marked with a triangle pointing inward, labeled '5b'. The right edge of the large rectangle is marked with a triangle pointing inward, labeled '5c'. The inner rectangle is defined by dashed lines and has a similar shape to the outer one, with its top and bottom edges also marked with triangles pointing inward.

4c

5b

5c

6c

4d

5c

opening

Hook & Loop
Tape

6d

6a

1. *Sushi Rice*

Cut 2 (facing)



6b

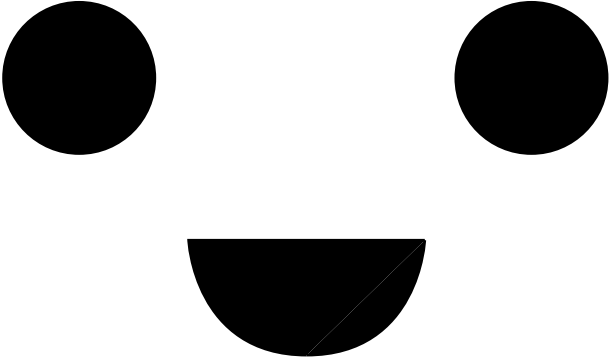

6. Tuna

Cut 3 - White Felt

6d

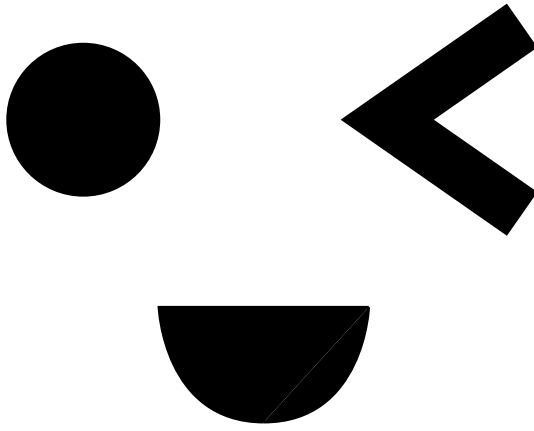

Sushi Set Cushions

make make co

makemakeco.net